

“quick dirty individual project”

MFA INTERACTION DESIGN | SVA | NYC

PUBLIC INTERFACES (IXG-6120-A)

WEEK 1: ASSIGNMENT

SEPTEMBER 15, 2015

MARCELO A. MEJIA COBO

What do you need to get by?

Yes!

You need Yonder.

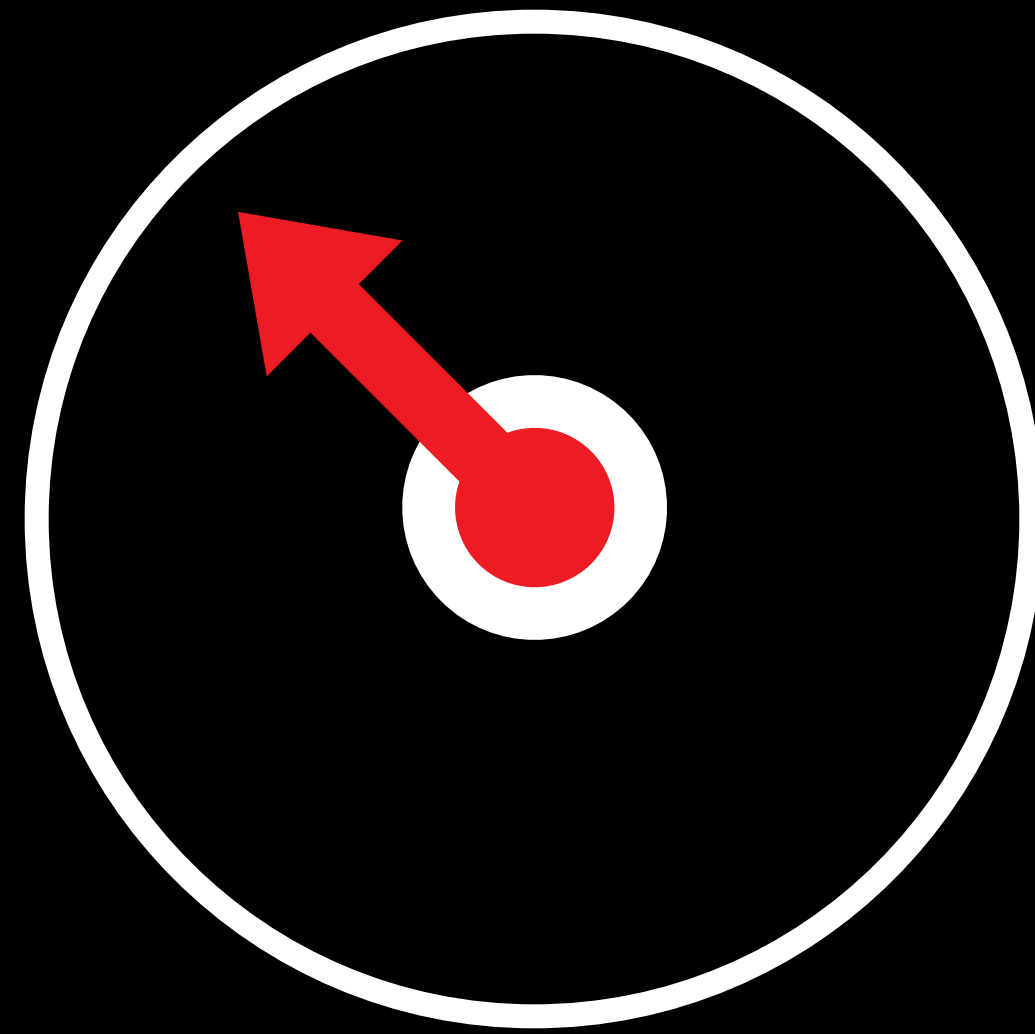

By Josh, Nic and Marcelo.



Pocket Park

Scenario Generation

Concept Name
Something memorable
POCKET PARK

Brief Description
What is it?
EASY-TO-READ LOCATION AND PARKING RULES

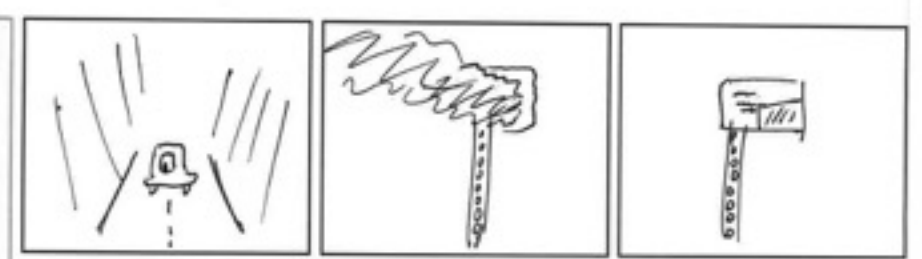

1 BOB IS DRIVING AROUND IN SEARCH OF A PARKING SPOT.

2 SOME OF THE PARKING SIGNS ARE OBSCURED BY TREES.

3 SOME ARE COVERED WITH STICKERS, OR TOO FADED TO READ.



4 HIS ATTENTION DIVERTED, HE NEARLY HITS A PEDESTRIAN.

5 NEXT TIME, BOB DOWNLOADS POCKET PARK.

6 MOUNTING HIS PHONE IN HIS CUPHOLDER, HE LAUNCHES THE APP.

7 NOW, AT A GLANCE, BOB KNOWS WHETHER HE'S FOUND A GOOD SPOT. THANKS, POCKET PARK!

Subway Entrances

MARCH/15

Scenario Generation

Concept Name
Something memorable
SUBWAY ENTRANCES

Brief Description
What is it?
A WAY OF LOCATING THE RIGHT SUBWAY ENTRANCE

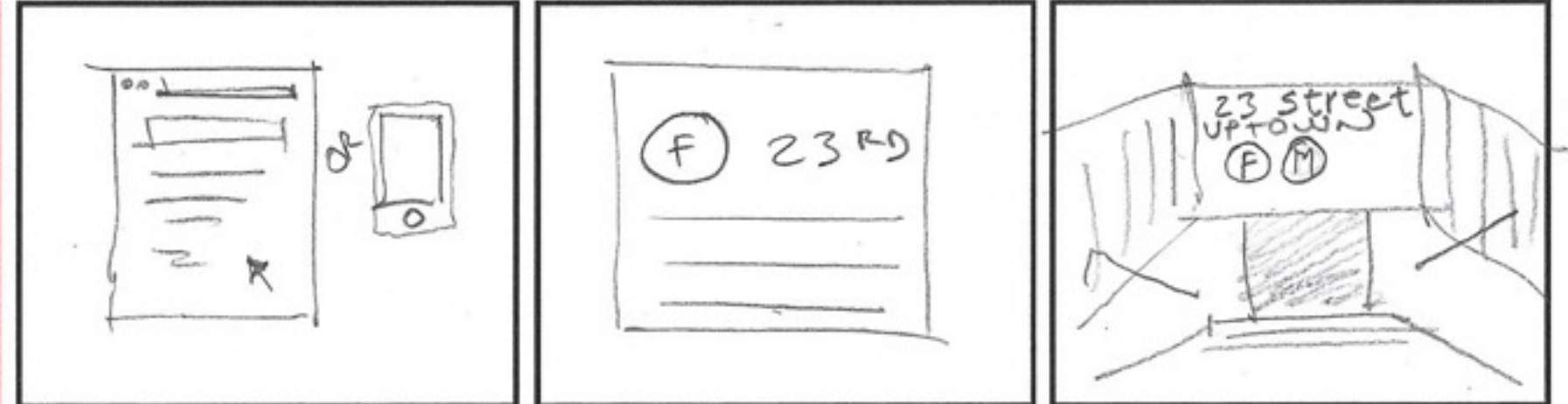

1 YOU GET DIRECTIONS TO GO TO A PLACES IN NYC.

2 THE RESULTS SHOW THE STATION ONLY BUT YOU WENT DOWNSTAIR AT THE OTHER SIDE.

3 YOU WANT TO GO DOWN TOWN BUT YOU WENT DOWNSTAIR AT THE OTHER SIDE.

4 YOU HAVE TO GO BACK UP AND CROSS THE STREET ETC.

5 NOW YOU ARRIVE TO YOUR DESTINATION BUT AGAIN YOU HAVE TO FIND THE RIGHT EXIT

6 YOU EMERGE FROM THE UNDERGROUND BUT YOU ARE DISORIENTED

7 BUT FORTUNATELY YOU HAVE THE SMART SUBWAY ENTRANCES APP THAT TELLS YOU THE WORTH

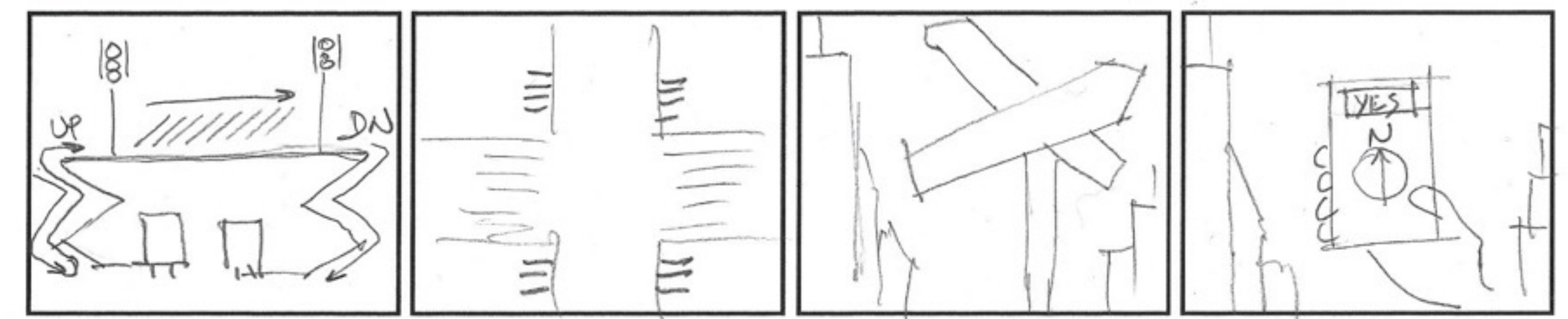

Freestyle

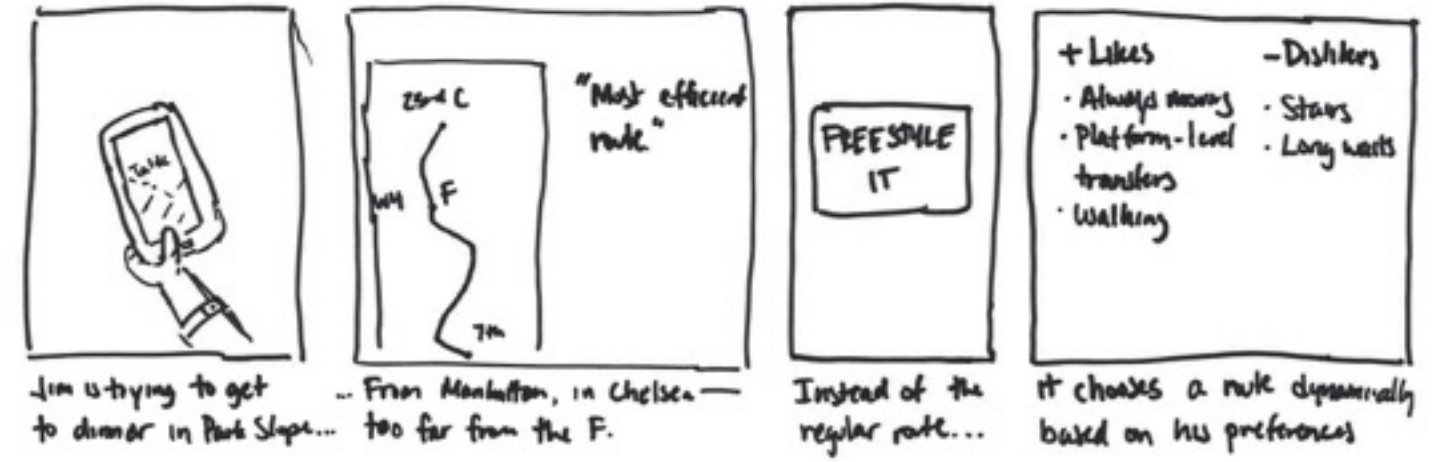

Jim is trying to get to dinner in Park Slope... From Manhattan, in Chelsea... too far from the F.

Instead of the regular route... it chooses a route differently based on his preferences

- + Likes: Always moving, Platform-level transfers, Walking
- Dislikes: Stairs, Long waits

And a commute can become tailored to your quirks which would you choose?

At W4, a D is arriving instead of the F... So it picks a more suitable route for Jim... but on the bridge, it gives a suggestion

... want a new FREESTYLE? Y N

Freestyle Way-finding

Magnetic Subway Entrances for Awareness



MICHAEL R. BLOOMBERG
Mayor, City of New York

AMANDA M. BURDEN, FAICP
Director, Department of City Planning

NEW YORK: A CITY OF NEIGHBORHOODS

DEPARTMENT OF CITY PLANNING
NEW YORK CITY

FACTS ABOUT NEW YORK CITY

GEOGRAPHY

Community Districts + Square Miles	59
Miles of Shoreline	304.8
Parks	578
Population Density	27,440 persons per square mile
Miles of Streets	6,375
Number of Bridges	2,027

DEMOGRAPHY

Total Population	8,363,710
White non-Hispanic	35%
Black non-Hispanic	23%
Asian non-Hispanic	12%
Hispanic (of any race)	28%
Foreign-born (number)	3,040,816
Foreign-born (percent)	36%
Languages Spoken	122,727
Births to City Residents in 2007	3,350,926
Total Housing Units	1,031,691
Owner-occupied	3,003,016
College-educated Residents	1.1 million
Public School Enrollment	

ECONOMY

New York City Budget (2009 FY)	\$59.5 billion
Median Household Income	\$51,116
Persons at Work in New York City	4,464,924
Workers Using Public Transportation	36%
Average Weekly Subway Ridership	5.2 million
New Housing Unit Permits in 2008	34,856
Private Businesses (with Payroll)	230,325
Restaurants	25,000
International and Domestic Visitors	47 million
Colleges and Universities	110
Public Library Materials in Circulation	65 million
Average Daily Water Consumption	1.1 billion gallons

Sources:
 NYC.gov, 2008
 Mayor's Management Report, 2009
 Metropolitan Transportation Authority, 2009
 NYC Department of Health and Mental Hygiene, 2007 and 2008
 NYC Department of Transportation, 2009
 NYC Office of Management and Budget, 2009
 NYC Department of City Planning, 2009/Quarterly Census of Employment and Wages, 2008
 NYC Department of Education, 2009
 U.S. Census Bureau, 2008 American Community Survey

New Amsterdam was explored by Giovanni Da Verrazano for France in 1524. Henry Hudson for the Netherlands in 1609 and finally settled by the Dutch West India Company in 1625. The next year, Peter Minuit, the first Director-General of New Netherlands, purchased Manhattan Island from the inhabitants. New Amsterdam was renamed New York after the Dutch surrendered to the British in 1664. New York City served as the capital of the United States from 1785 to 1790.

The first great waves of immigration to New York City began in the 1830s, launching an unprecedented increase in the city's population, which reached one million persons in 1860. The five boroughs of New York City were formally consolidated in 1898. In 1968, Community Planning Boards and Districts were created to advise the Borough Presidents and city agencies on planning and service issues. This map shows neighborhood names and the Community District boundaries as revised in 1995.

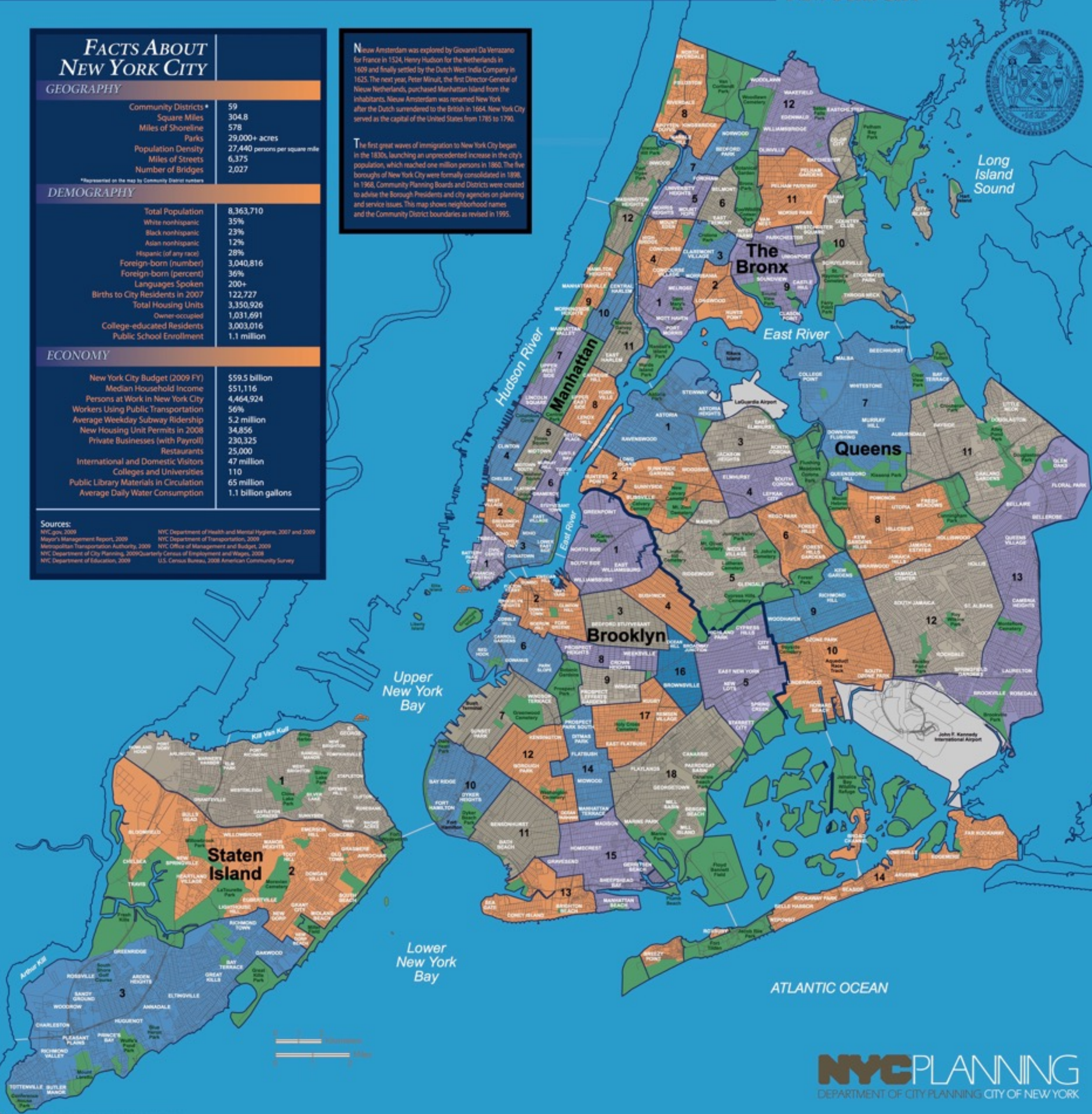

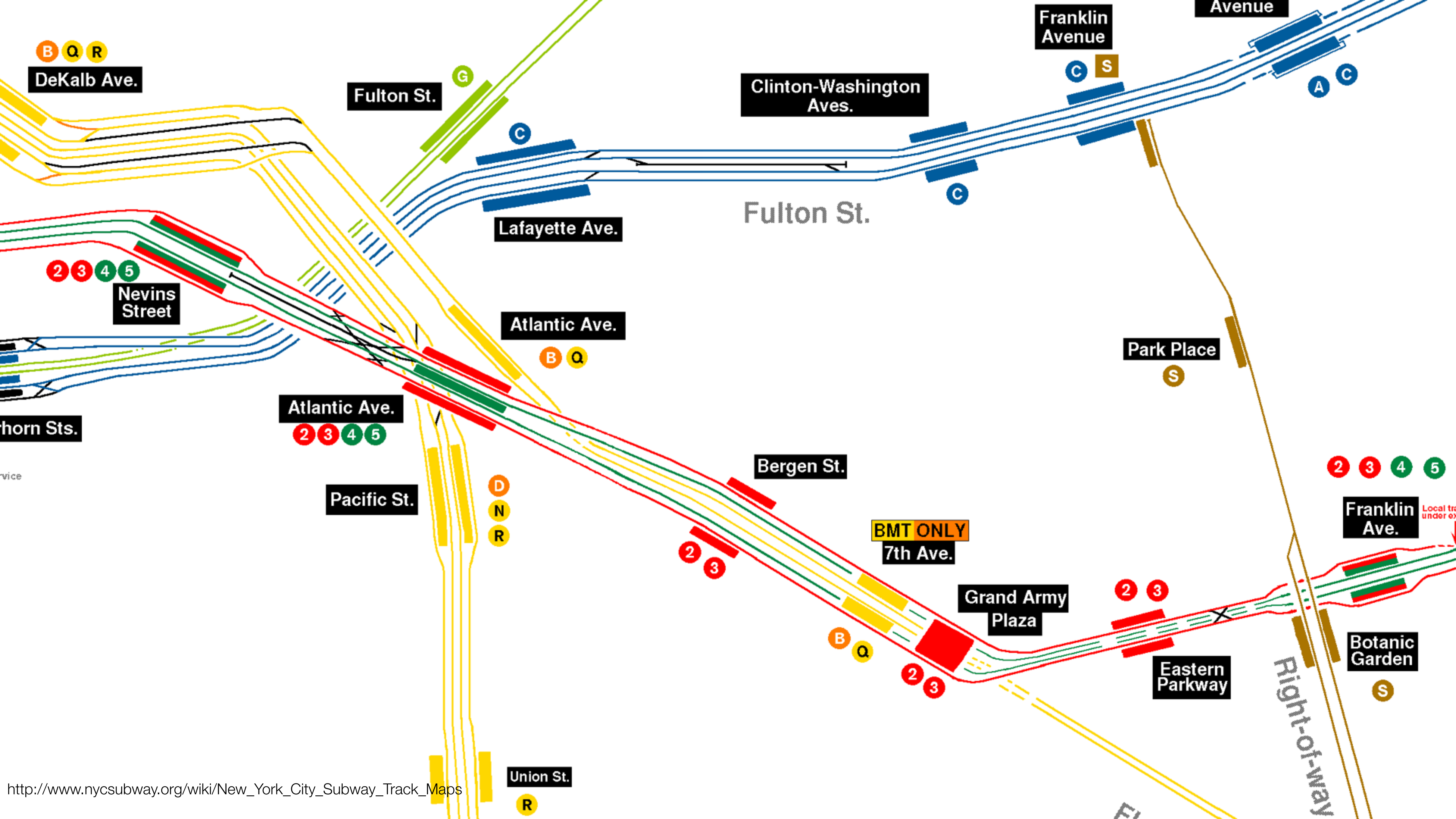

What do you need to get by?

Yes!

You need reference points.

PARK AV

ONE WAY

DEPT. OF TRANSPORTATION

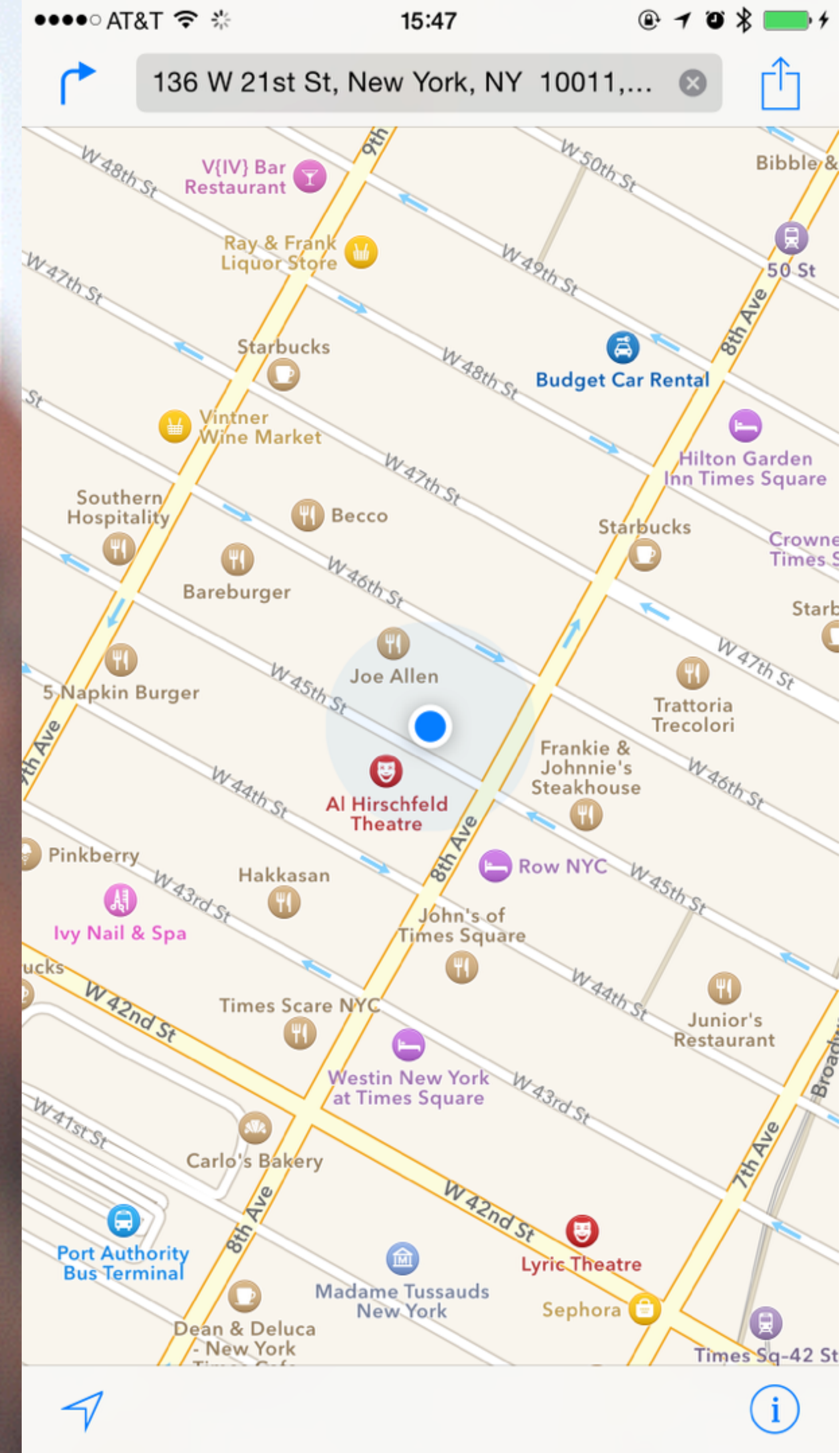

Ammassalik wooden maps are carved, tactile maps of the Greenlandic coastlines.

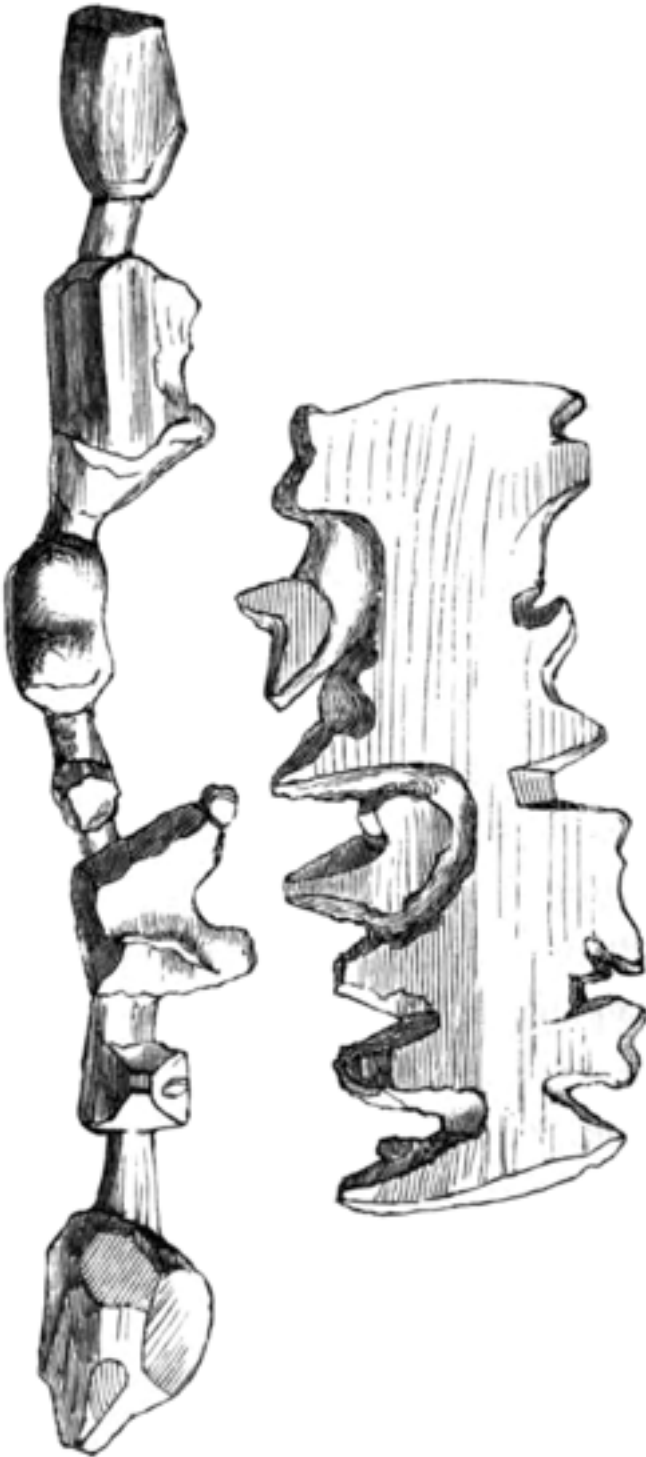

Wikipedia



Figur 2. Kuniits tre udskårne trækort af strækningen fra Sermiligaaq til Kangertittivatsiaq. Kortet til højre viser øerne langs kysten, mens kortet i midten viser fastlandet og er fortløbende fra den ene side af klodsen til den anden. Kortet til venstre viser halvøen mellem fjordene. Udsnit af Geodætisk Instituts kortblade Grønland 1:250.000, 65 Ø1, 65 Ø2 samt 66 Ø2.



<http://visitworldplaces.com/photo/places/compass-rose/02/>



Wikipedia

<http://www.m4040.com/Survival/Skills/Navigation/Navigation.htm>

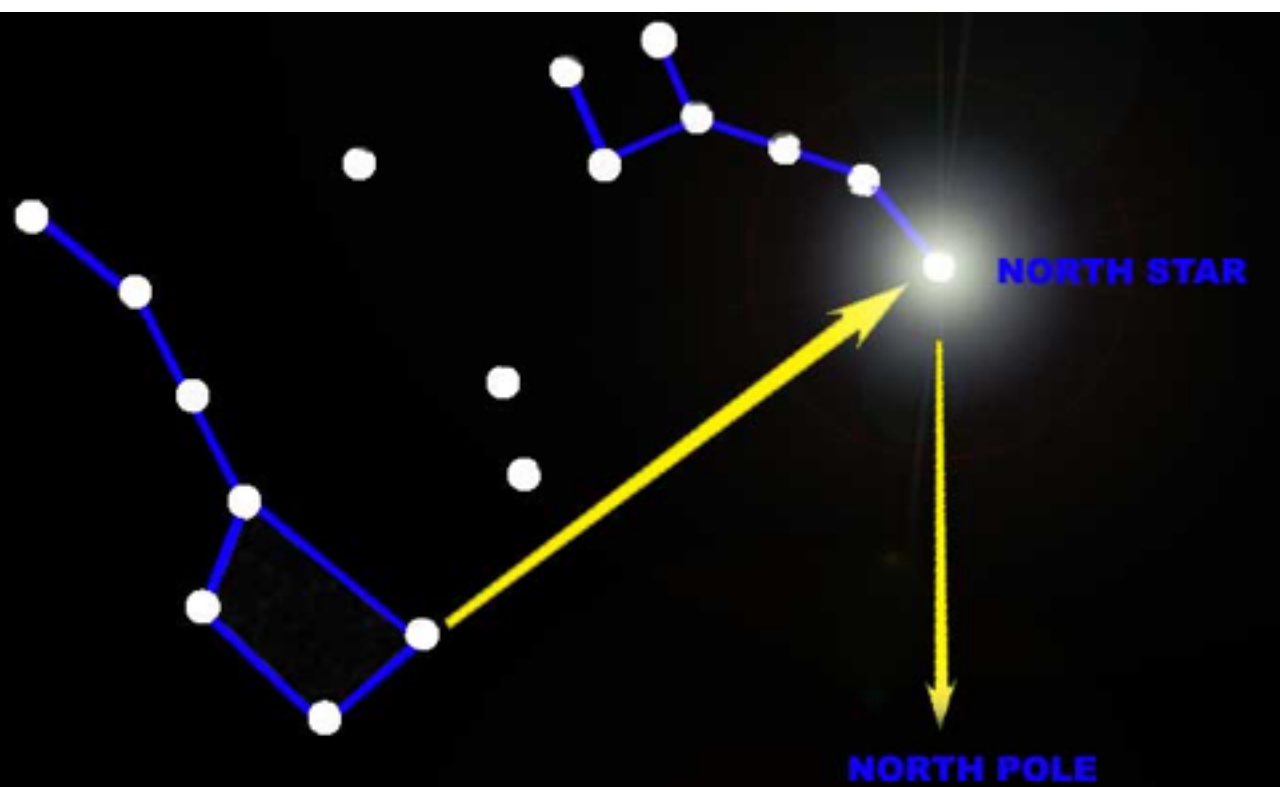

Static Interactions





Magnetic North Subway Entrance/Platform Glance

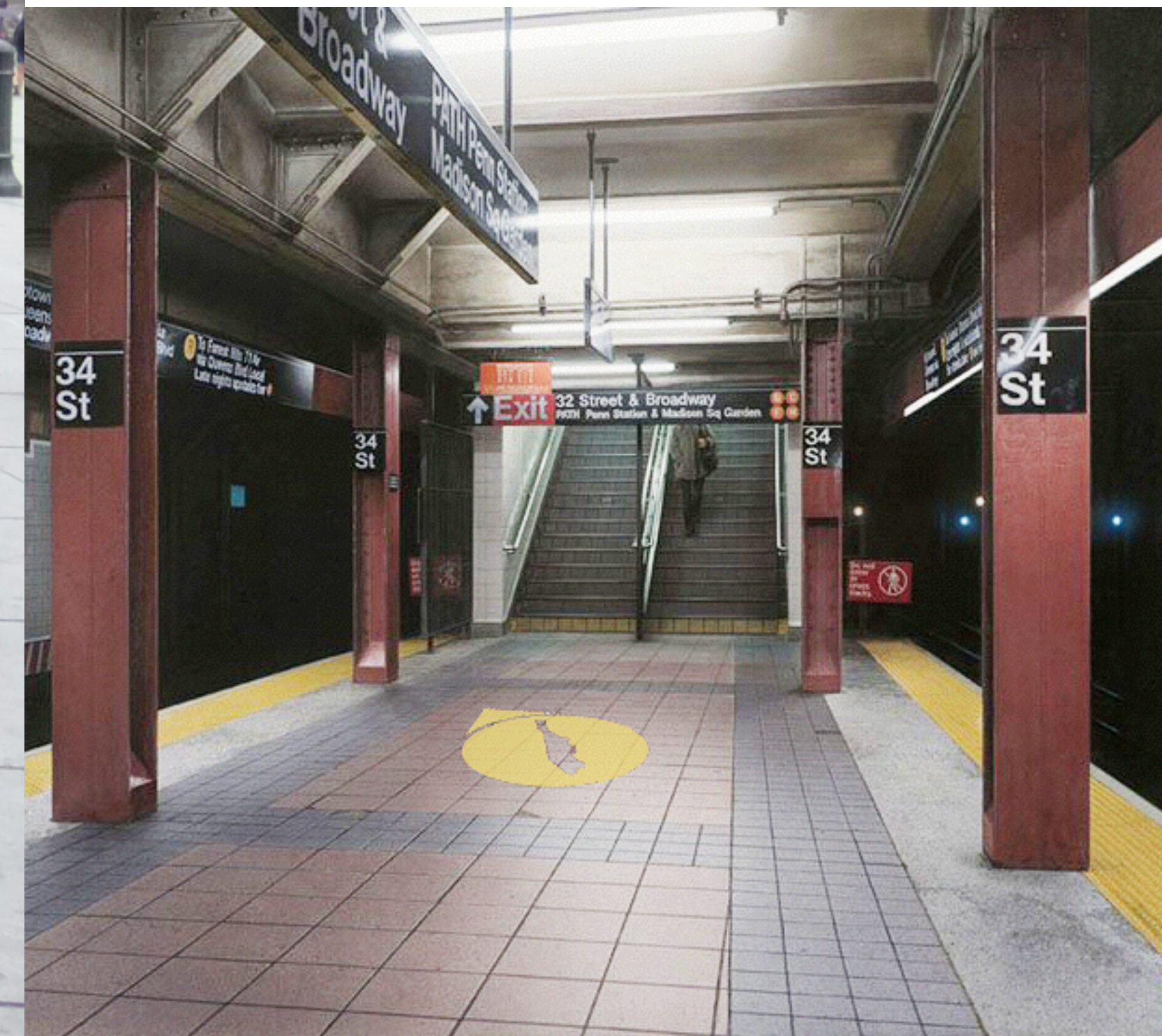

Thank you

MFA INTERACTION DESIGN | SVA | NYC
PUBLIC INTERFACES (IXG-6120-A)
WEEK 1: ASSIGNMENT
SEPTEMBER 15, 2015

MARCELO A. MEJIA COBO